

EXTRAS DE ARMARE

Elem.	Marca	Φ	Lung. unei bare (m)	Bare pe elem.	Nr. elem.	Nr. bare asem.	Lung. pe diametre (m)				
							OB37 Φ6	Φ8	Φ10	Φ12	Φ14
Det.1	1	8	2.15	95	1	95	-	204.25	-	-	-
	2	8	2.38	90	1	90	-	214.20	-	-	-
	3	8	2.91	180	1	180	-	523.80	-	-	-
	4	8	1.00	94	1	94	-	94.00	-	-	-
	5	8	0.40	210	1	210	-	84.00	-	-	-
det.2	1	8	2.15	30	1	30	-	64.50	-	-	-
	2	8	2.38	31	1	31	-	73.78	-	-	-
	3	8	2.91	62	1	62	-	180.42	-	-	-
	4	8	1.00	32	1	32	-	32.00	-	-	-
	5	8	0.40	65	1	65	-	26.00	-	-	-
det.3+4	1	8	2.15	32	1	32	-	68.80	-	-	-
	2	8	2.38	30	1	30	-	71.40	-	-	-
	3	8	2.91	60	1	60	-	174.60	-	-	-
	4	8	0.40	60	1	60	-	24.00	-	-	-
	5	8	0.40	60	1	60	-	24.00	-	-	-
det.5	1	8	2.15	6	1	6	-	12.90	-	-	-
	2	8	2.00	6	1	6	-	12.00	-	-	-
	3	12	2.50	3	1	3	-	-	7.50	-	-
	4	8	2.15	10	1	10	-	21.50	-	-	-
	5	8	2.38	10	1	10	-	23.80	-	-	-
det.6	1	8	2.91	20	1	20	-	58.20	-	-	-
	2	8	0.40	22	1	22	-	8.80	-	-	-
	3	8	2.15	14	1	14	-	30.10	-	-	-
	4	8	2.38	14	1	14	-	33.32	-	-	-
	5	8	2.91	12	1	12	-	34.92	-	-	-
det.7	1	8	1.90	20	1	20	-	38.00	-	-	-
	2	8	2.15	14	1	14	-	30.10	-	-	-
	3	8	2.38	14	1	14	-	33.32	-	-	-
	4	8	2.91	12	1	12	-	34.92	-	-	-
	5	12	3.60	3	1	3	-	-	10.80	-	-
det.8+9	1	8	0.40	28	1	28	-	11.20	-	-	-
	2	8	1.95	74	1	74	-	144.30	-	-	-
	3	8	2.33	72	1	72	-	167.76	-	-	-
	4	8	2.86	144	1	144	-	411.84	-	-	-
	5	8	0.95	72	1	72	-	68.40	-	-	-
det.10	1	8	0.35	120	1	120	-	42.00	-	-	-
	2	8	11.00	1	1	1	11	-	-	-	-
	3	8	1.95	9	1	9	-	17.55	-	-	-
	4	8	2.33	10	1	10	-	23.30	-	-	-
	5	8	2.25	20	1	20	-	45.00	-	-	-
det.11	1	8	0.95	8	1	8	-	7.60	-	-	-
	2	8	0.35	20	1	20	-	7.00	-	-	-
	3	8	1.95	14	1	14	-	27.30	-	-	-
	4	12	4.00	3	1	3	-	-	12.00	-	-
	5	8	1.90	19	1	19	-	36.10	-	-	-
det.12	1	10	1.70	18	1	18	-	-	30.60	-	-
	2	10	2.15	28	2	56	-	120.40	-	-	-
	3	14	7.80	3	2	6	-	-	-	46.80	-
	4	8	1.90	32	2	64	-	121.60	-	-	-
	5	8	1.95	6	1	6	-	11.70	-	-	-
det.13	1	8	2.70	3	1	3	-	-	8.10	-	-
	2	12	2.70	3	1	3	-	-	-	-	-
	3	8	1.90	7	1	7	-	13.30	-	-	-
	4	12	1.62	18	1	18	-	-	29.16	-	-
	5	14	7.78	6	1	6	-	-	-	46.68	-
det.14	1	10	7.45	2	1	2	-	14.90	-	-	-
	2	8	1.90	34	1	34	-	64.60	-	-	-
	3	8	0.40	34	1	34	-	13.60	-	-	-
	4	8	0.40	34	1	34	-	13.60	-	-	-
	5	12	5.00	6	1	6	-	-	30.00	-	-
det.15	1	10	4.70	2	1	2	-	9.40	-	-	-
	2	8	1.90	20	1	20	-	38.00	-	-	-
	3	8	0.40	20	1	20	-	8.00	-	-	-
	4	8	0.40	20	1	20	-	8.00	-	-	-
	5	12	4.55	6	1	6	-	-	27.30	-	-
det.16	1	10	4.25	2	1	2	-	8.50	-	-	-
	2	8	1.90	16	1	16	-	30.40	-	-	-
	3	8	0.40	16	1	16	-	6.40	-	-	-
	4	8	0.40	16	1	16	-	6.40	-	-	-
	5	12	4.55	6	1	6	-	-	27.30	-	-
TOTAL LUNGIMI PE DIAMETRU							11.00	3427.68	153.20	155.46	93.48
GREUTATEA PE METRU							0.222	0.395	0.617	0.888	1.210
TOTAL GREUTATE PE DIAMETRU							2.44	1353.93	94.52	138.05	113.11
TOTAL GENERAL (kg)							2 kg	1,700 kg			

pardoseala finita
pardoseala b.a.C16/20-10cm
armata cu plase #Ø6/100
polistiren extrudat
hidroizolatie membrane
beton egalizare-5cm
pietris compactat-10cm

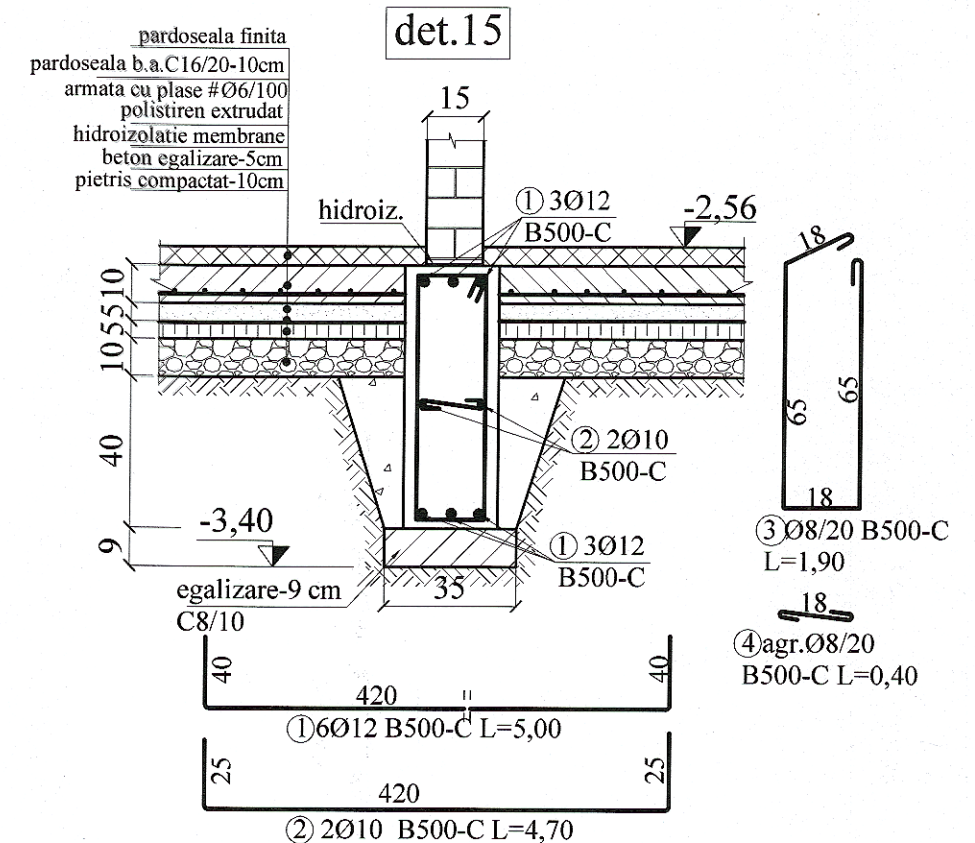
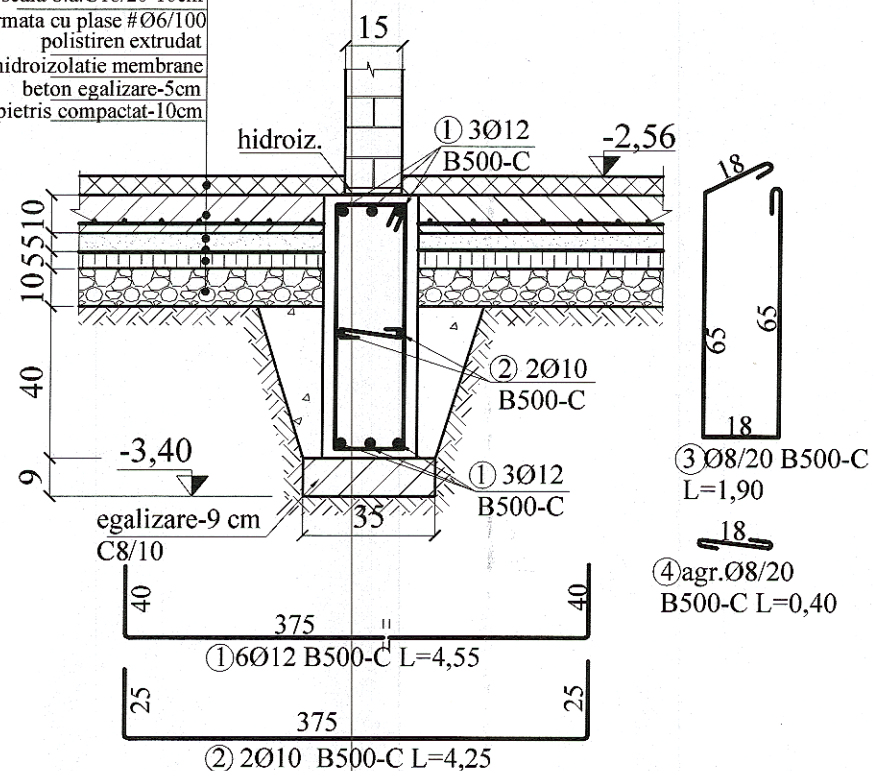

Pentru pardoseala subsol se va monta un singur rand de plasa Ø6/100x100, la partea de jos. Plasele vor patrunde 10cm in centuri
Plase sudate pardoseala subsol
Ø6/100x100-510 kg

MATERIALE:

Beton: cf. NE012/2022

-egalizare

C8/10/XO/IIAS32,5R/D0-31/T3(S2)

-cuzinet/grinzi fundare+pereti

C20/25/XC1/IIAS42,5R/D0-16/T3

Otel beton conform ST 009-2011:

B500-C

- Rezistenta la rupere - 550N/mmp

- Rezistenta de calcul - $f_y=500N/mmp$

- Alungire - 10%

- Alungire A5-minim 20%

ab = 3,5 cm - fundatii

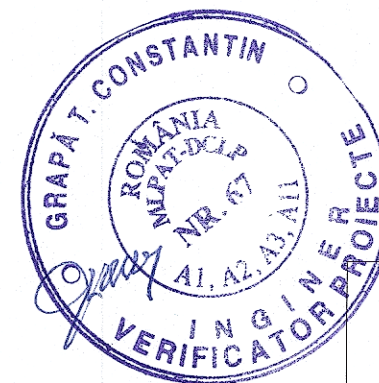

PROIECTANT GENERAL: S.C. PRODUMUS S.R.L. BACAU -PR.NR.3/2024

Semnificatie		Nume si prenume		Semnatura		Referat / numar / data		
PROIECTANT DE SPECIALITATE - STRUCTURA						Titlu de proiect : CONSTRUIRE CAMIN DE BATRANI		Proiect nr. 1/ 2024
SC PROCES SRL						ORGANIZARE DE SANTIER		
J37/472/2004 CUI -16577944						Amplasament : str. Calea Romanului nr. 191, mun. Bacau ,jud. Bacau		
loc.LAZA,jud.VASLUI tel.: 0742058048								
Semnificatie	Nume si prenume	Semnatura	Scara	Beneficiar :				faza
Sef.proiect	arh. Catuneanu Marian		1/ 20	LUCA GHEORGHE si LUCA ELENA				P.T.H.
Proiectat	ing. Asavei Ciprian		Data	Titlul plansei : DETALII FUNDATII- Det. 15-16				Plansa
Desenat	ing. Asavei Ciprian		2024	EXTRAS ARMARE FUNDATII SI PERETI SUBSOL				R-8

1125